

GROUND FLOOR PLAN

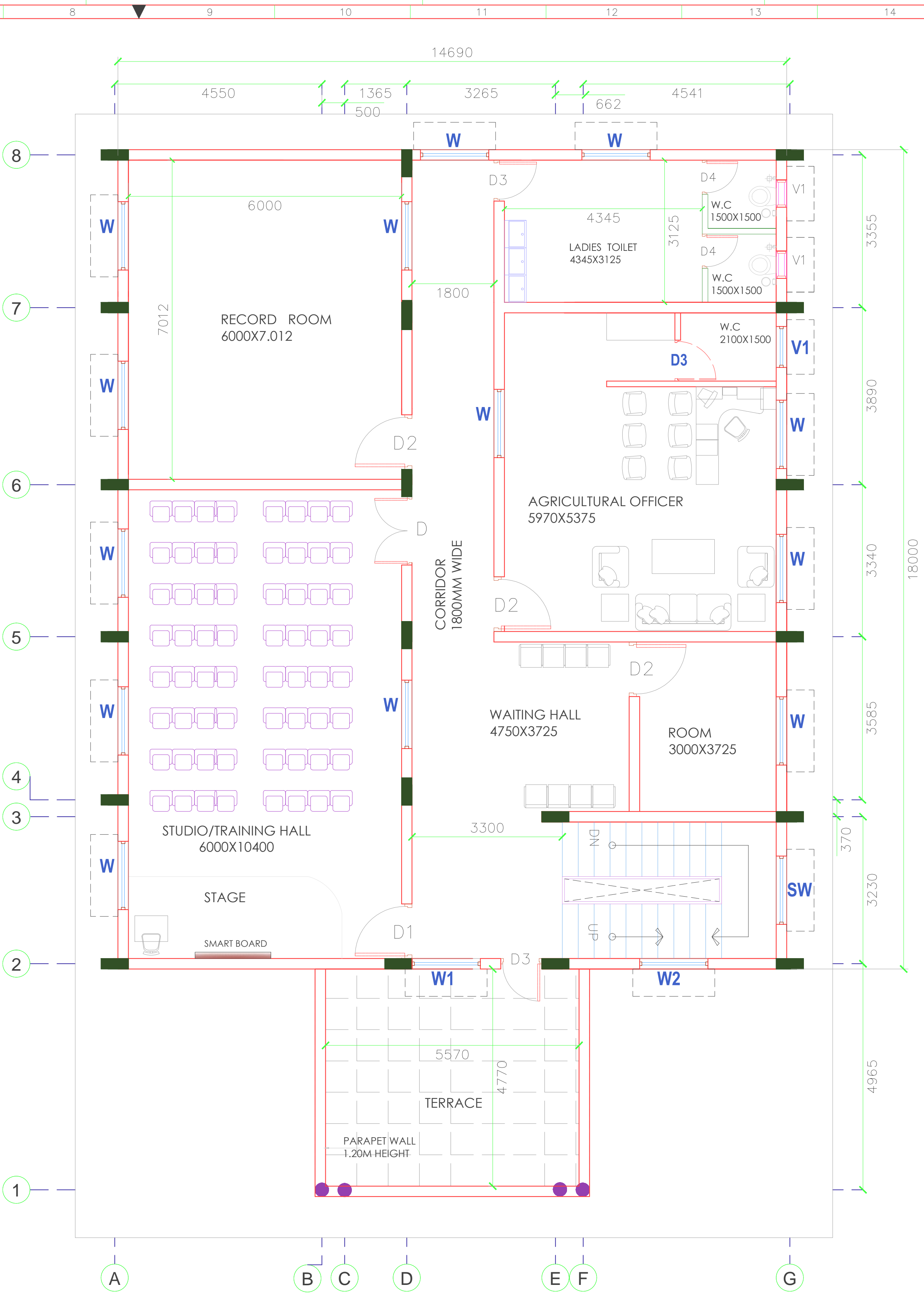

FIRST FLOOR PLAN

NOTE:  
1.DO NOT SCALE. THE DRAWING FOLLOW TH WRITTEN DIMINSON ONLY.  
2.ALL DIMENSIONS ARE IN mm UNLESS NOTED OTHERWISE.  
3.GROUND+1 FLOOR STRUCTURE.  
4.FLOOR TO FLOOR 3600mm HEIGHT.  
5.ANY CHANGES SHOULD BE BROUGHT TO THE NOTICE ARCHITECH

SCHEDULE OF OPENING					
TYPE	SIZE	SILL HT	LINTEL HT	FRAME	SHUTTERS
DOORS:					
RS	3000X3000	-	-	MILD STEEL	
ED	1800X2400	-	2400	HONNE	HONNE
D	1500X2400	-	2400	HONNE	FLUSH DOOR
D1	1200X2400	-	2400	HONNE	FLUSH DOOR
D2	900X2400	-	2400	HONNE	FLUSH DOOR
D3	750X2100	-	2100	WPC	WPC
WINDOWS:					
W1	900X1500	900		UPVC	2TRACK
W	1500X1500	900		UPVC	2TRACK
SW	1200X1350			UPVC	2TRACK
W2	1500X900			UPVC	2TRACK
VENTILATORS:					
V	1500X600	1800		UPVC	louvered
V1	900X600	1800		UPVC	louvered

CLIENT: AGRICULTURE DEPARTMENT (KSDA)	
IMPLEMENTING AGENCY : Planning and Road Asset Management Centre (PRAMC)-PWD	
DRAWING TITLE : GROUND & FIRST FLOOR PLAN	
PROJECT TITLE : CONSTRUCTION OF RAITHA SAMPARKA KENDRA AND GODOWN BUILDING FOR AGRICULTURE DEPARTMENT AT PAATAPALYA HOBLI, BAGEPALLI TALUK, CHIKKABALLAPURA DISTRICT .	
DRAW : DESIGNED: CHECKED: APPROVED:	ORIENTATION: 
DWG No :1 SCALE:N.T.S	
CONSULTANT:	
ASSISTANT EXECUTIVE ENGINEER PRAMC	ASSISTANT ENGINEER PRAMC
	EXECUTIVE ENGINEER PRAMC

AREA STATEMENT	
DESCRIPTION	AREA(SQ/M)
GROUND FLOOR	295.00
FIRST FLOOR	264.50
HEAD ROOM	22.50
TOTAL ARAE	582.00